

## Go City Step-by-Step Redemption Guide - Seoul Land

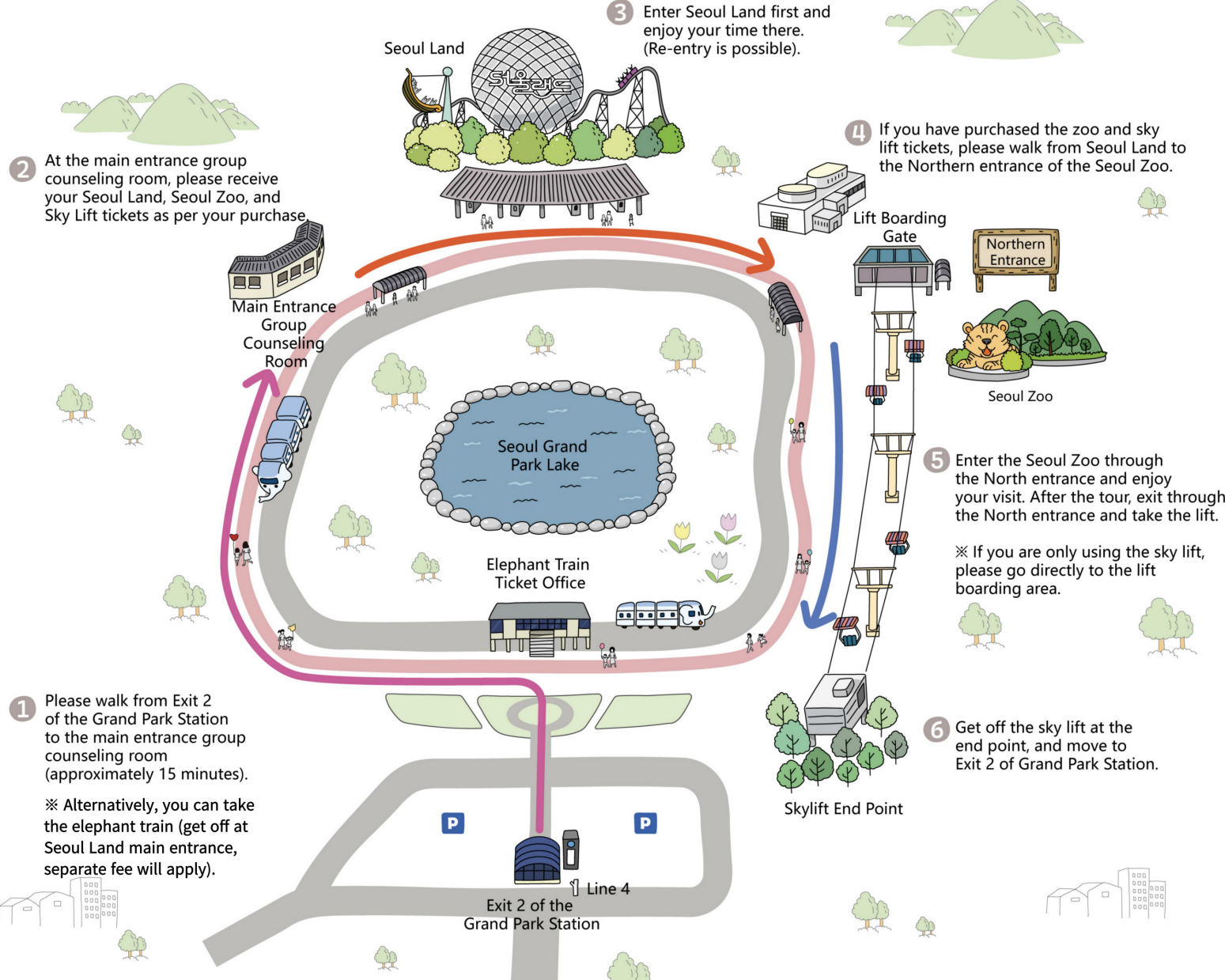

Please follow these instructions for your Seoul Land package

### How to get there



Walk from Exit 2 of the Grand Park Station



Walk to Elephant Train Ticket Office direction



You will need to walk for 5 minutes. Enter the building and get to the Elephant Train Ticket Office

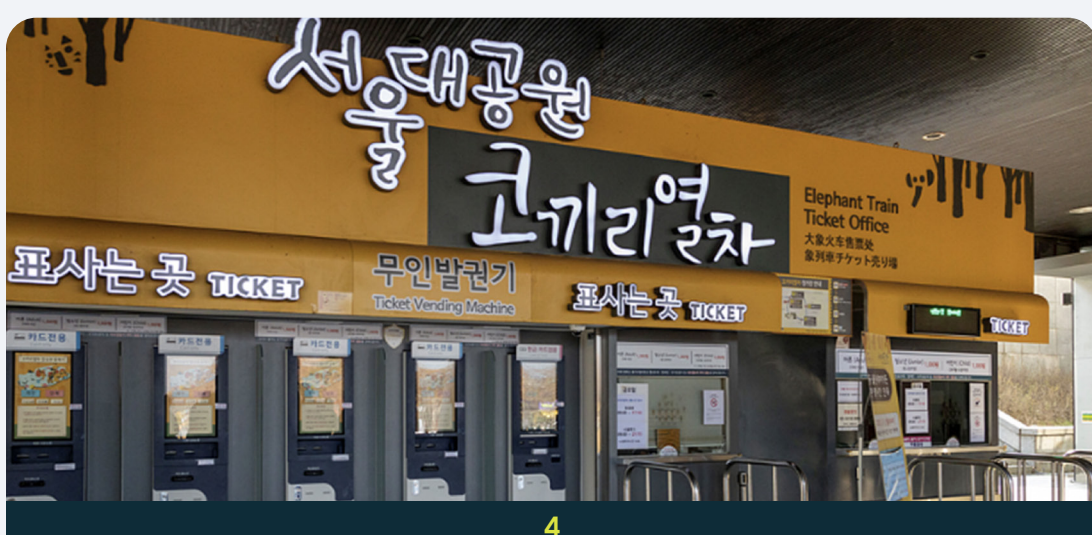

Purchase Elephant train ticket (one way) at the ticketing counter



Take elephant train



Take off at Seoul Land Station and find Group Sales & Annual Membership information center

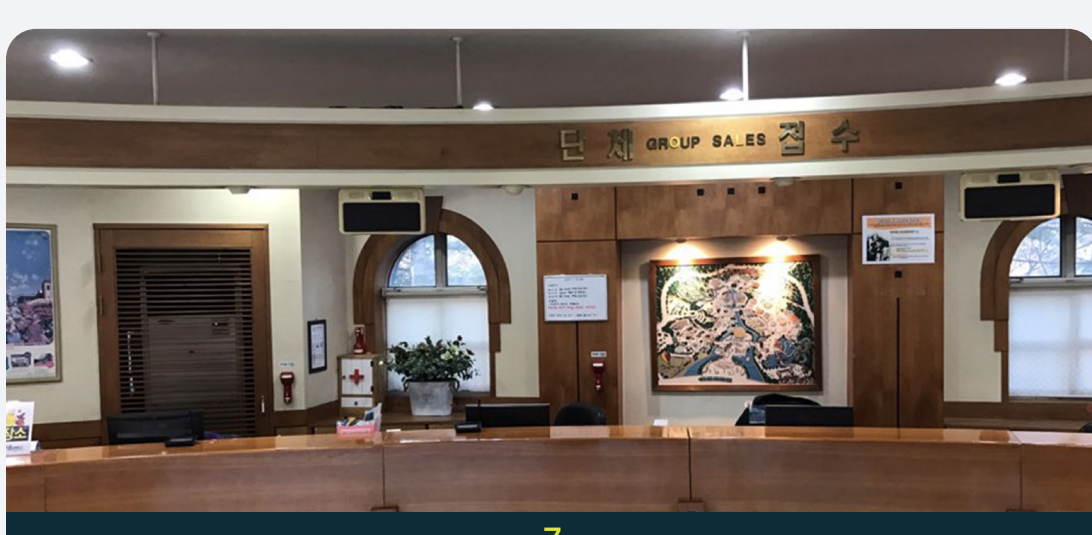

Show your pass.  
You'll receive Seoul Land, Seoul Zoo and one way cable car ticket